

6001-2Z Deep groove ball

bearings

- Popular item
- SKF Explorer

Deep groove ball bearings

Bearing data

[Tolerances](#),

Normal (metric), P6, P5, Normal (inch),

[Radial internal clearance](#),

Matched bearing pairs, Stainless steel
d < 10 mm, Other bearings

Bearing interfaces

[Seat tolerances for standard conditions](#),

[Tolerances and resultant fits](#)

Technical specification

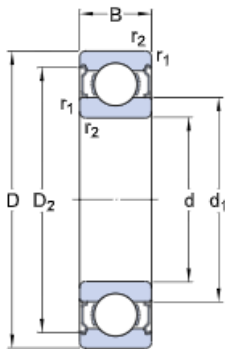

DIMENSIONS

d	12 mm	Bore diameter
D	28 mm	Outside diameter
B	8 mm	Width
d ₁	≈ 17 mm	Shoulder diameter
D ₂	≈ 24.72 mm	Recess diameter
r _{1,2}	min. 0.3 mm	Chamfer dimension

ABUTMENT DIMENSIONS

d _c min.	14 mm	Diameter of shaft abutment
d _c max.	16.9 mm	Diameter of shaft abutment
D _i max.	26 mm	Diameter of housing abutment
r _a max.	0.3 mm	Radius of shaft or housing fillet

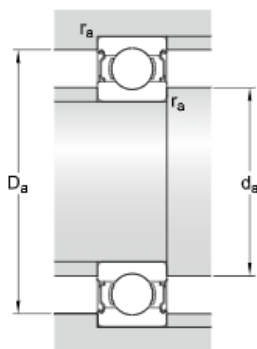

CALCULATION DATA

C	5.4 kN	Basic dynamic load rating
C ₀	2.36 kN	Basic static load rating
P _u	0.1 kN	Fatigue load limit
	60 000 r/min	Reference speed
	30 000 r/min	Limiting speed
k _r	0.025	Minimum load factor
f ₀	13	Calculation factor

MASS

	0.022 kg	Mass bearing
--	----------	--------------

TOLERANCE CLASS

P6	Dimensional tolerances
P5	Radial run-out